

NOTES:
 SWIMMING POOL INSTALLATION TO COMPLY WITH AS 1926.3.2010
 POOL BARRIERS TO COMPLY WITH 1926-2012
 POOL VACINITY TO BE MADE SAFE TO NCC REQUIREMENTS

NOTES:
 NO TREES TO BE REMOVED

ELECTRICAL COMPONENTS SHALL BE LOCATED ABOVE KNOWN DESIGNATED FLOOD LEVELS

SWIMMING POOL INSTALLATION TO COMPLY WITH AS 1926.3.2010

POOL BARRIERS TO COMPLY WITH AS 1926-2012

CONNECTION OF THE BACKWASH TO THE SEWER IS TO BE IN ACCORDANCE WITH AS 3500

LEVELS, DIMENSION, BOUNDARIES SHOWN ARE APPROXIMATE ONLY. CONFIRM WITH SURVEY AS REQUIRED. CONFIRM INFRASTRUCTURE LOCATIONS PRIOR TO EXCAVATION (INCLUDING BUT NOT LIMITED TO : SEWER, STORMWATER, WATER, ELECTRICAL, TELSTRA, NBN).

TOP OF POOL HEIGHTS:
MAX 600mm ABOVE NGL

SECTION A

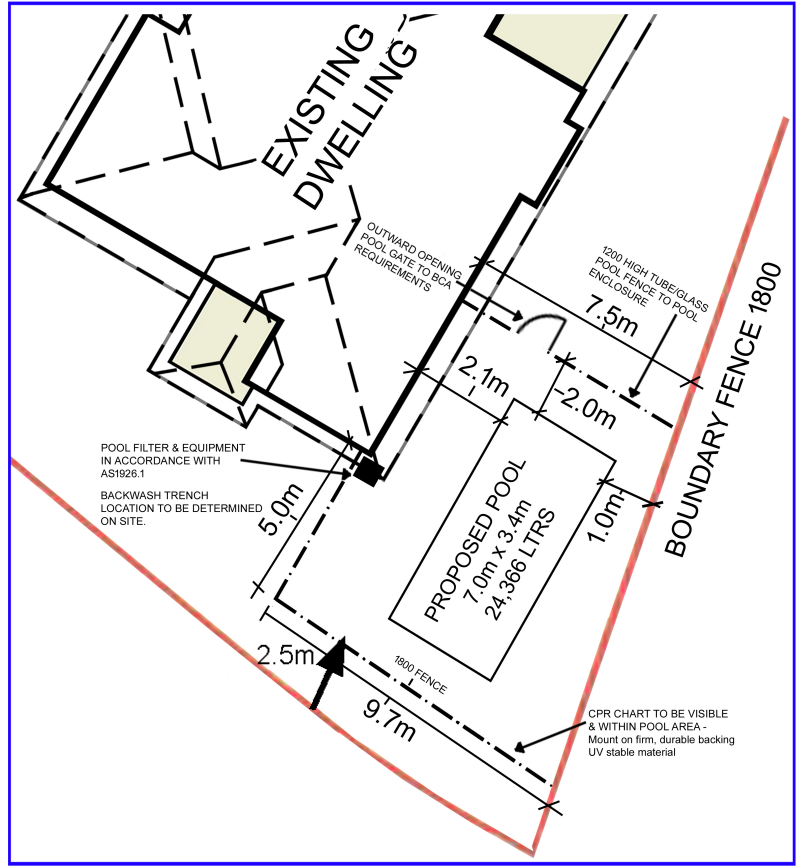

PHOENIX POOLS PTY LTD
 61 WATERMAN STREET, OLD BAR NSW 2430
 ABN: 83631990942

CLIENT: SCOTT TROTTER & SAMANTHA HULL	ADDRESS: 3 HOWARD STREET, WALLABI POINT NSW 2430	LOT: 125 DP: 1223777	DRAWN BY: GREG ROUND DATE: 20/11/2024 LITRES: 24,366 LTRS	SCALE: PROPERTY DIMENSIONS PROJECT: PROPOSED INGROUND FIBREGLOSS POOL
--	---	---	--	--